

## Quick Installation Guide

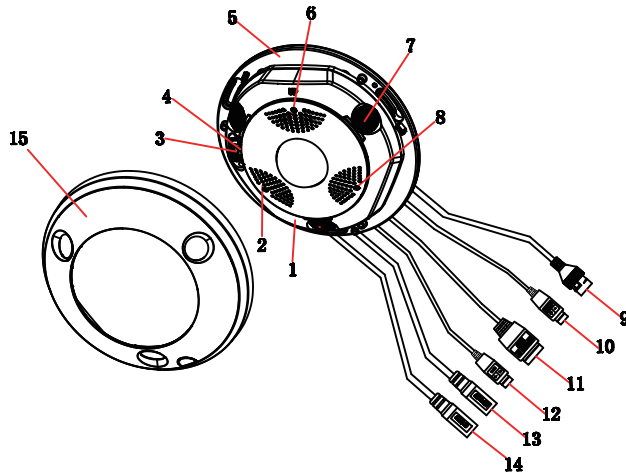

No.	Description	No.	Description
1	Upper Cover	9	Ethernet Interface
2	MIC	10	Power Interface
3	Micro SD Card Slot	11	Alarm Interfaces
4	Reset Key	12	RS485 Interface
5	Lower Cover	13	Audio Out
6	Speaker	14	Audio In
7	IR	15	Camera Cover
8	MIC		

### 1. Disassembling the Camera

#### Steps:

1. Loosen the lock screw on the camera cover.
2. Remove the camera cover, and you can see the oval dismantable sheet.
3. Loosen the two screws on the dismantable part.
4. Move the oval sheet aside, and you can see the reset button and the micro SD card slot.

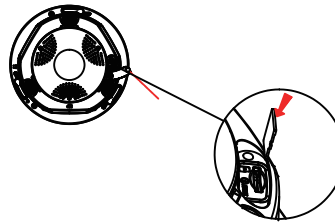

#### Note:

Press RESET about 10 s when the camera is powering on or rebooting to restore the default settings, including the user name, password, IP address, and port No., etc.

### 2. Ceiling Mounting

#### Steps:

1. Drill three screw holes and the cable hole according to the supplied drill template.
2. Fix the three supplied screws half-deep to the ceiling, leaving enough space to hook the camera body.

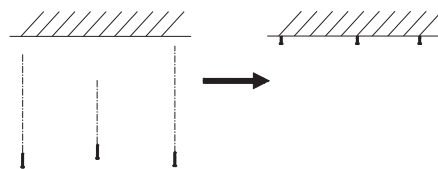
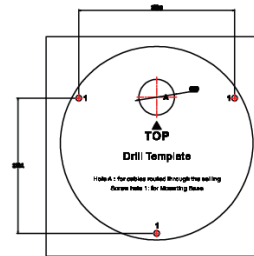

3. Connect the corresponding power cable, network cable, audio and alarm cables.
4. Align the screw holes to the inserted screws, hook the camera body to the screws, and route the camera body to secure the camera with the screws.
5. Hammer the half-deep screws into the ceiling totally.
6. Install the camera cover to the camera body, and fix them by tightening the lock screw on the camera cover.

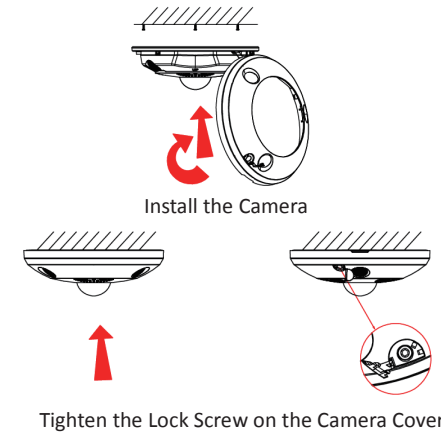

### 3. Wall Mounting with a Junction Box

You have to purchase a junction box separately if this mounting method is selected.

#### Steps:

1. Fix the junction box to the wall with screws.
2. Screw the three supplied screws half-deep to the junction box.
3. Connect the corresponding power cable, network cable, audio and alarm cables.
4. Align the screw holes to the inserted screws, hook the camera body to the screws, and route the camera body to secure the camera with the screws.
5. Screw the half-deep screws into the wall totally.
6. Install the camera cover to the camera body, and fix them by tightening the screw on the camera cover.

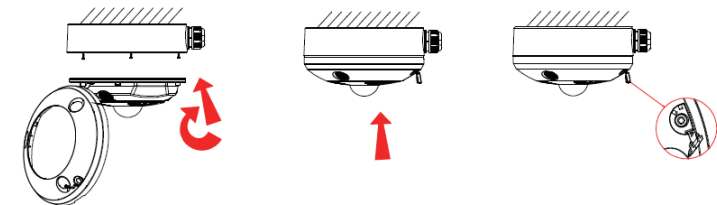

For detailed instructions of further configuration, please refer to the user manual of network camera.